

Foster -
Luzerne.

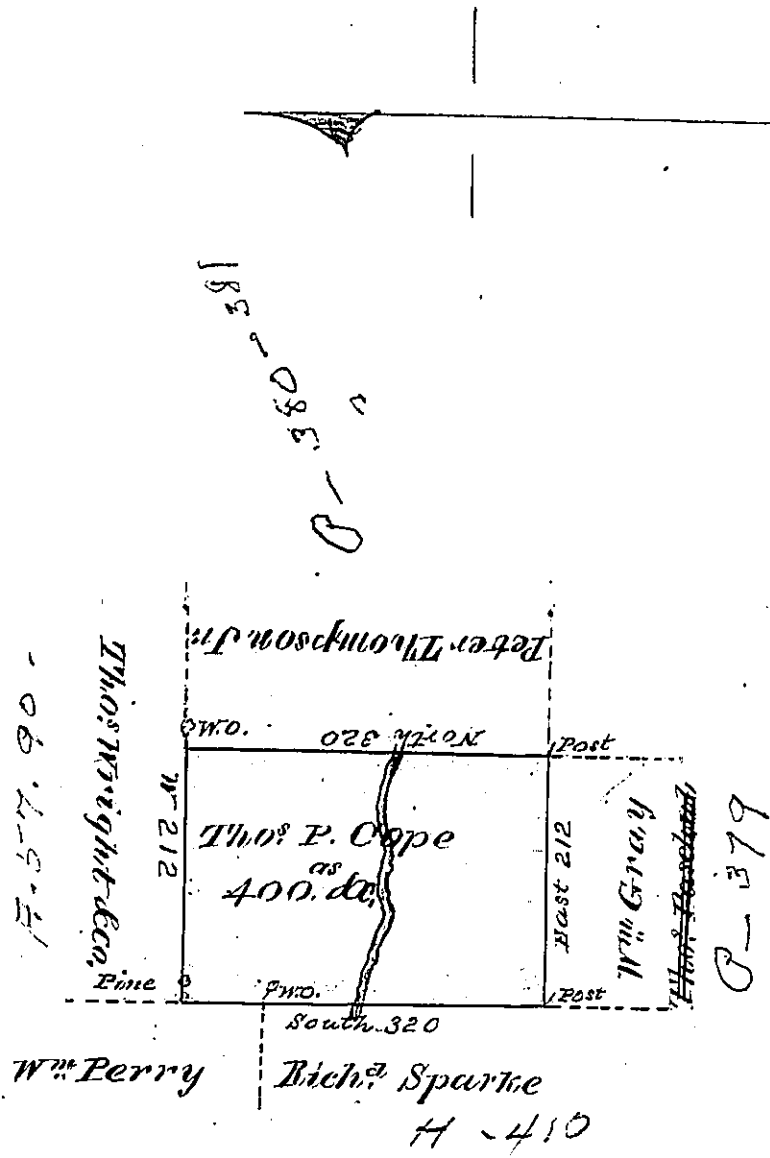

A Draft of a tract of land called
 Situate in the County of Luzerne containing
 four Hundred acres & allow: Surveyed for
 Thos P. in the 16th day of Sept: 1793 by virtue
 of a warrant dated the 6th of August 1793.

Daniel Brodhead Esq^r }
 Suror: Genl }

by Wm Gray

IN TESTIMONY that the above is a copy of the original remaining on file in the
 Department of Internal Affairs of Pennsylvania, made con-
 formably to an Act of Assembly approved the 16th day of
 February, 1833, I have hereunto set my Hand and caused
 the Seal of said Department to be affixed at Harrisburg, this

Twenty eighth day of July 1876

Wm McAuley
 Secretary of Internal Affairs